

Lighting Poles



المير للصناعات ALMEER INDUSTRIES

www.almeer.com.kw



شركة المير للخدمات الفنية ذ.م.م.

Subsidiary of ALMEER TECHNICAL SERVICES CO. W.L.L.





INTRODUCTION

We strive to provide reliable, highest quality and economic solutions to our customers. As we continue to build and strengthen our partnership, we are committed to achieve 100% customer satisfaction and earn your trust and loyalty.

Almeer Industries established in the year 1997, has been in the business offering a wide range of services in manufacture of Panels for various applications, Street Lighting Poles, Junction Boxes, Cable Trays & Accessories, Unistrut Channels, Wire mesh, Expanded metal, Profiled Sheets etc., for Oil & Gas, Petrochemical, Power and other major industries in Kuwait. It is an ISO 9001: 2008, ISO 14001: 2004 & ISO 18001: 2007 Certified Company with standardization worked into all facets of its work.

Almeer manufacturing facility is located in Amghara Industrial Area with modern machineries and equipments. The workshop is located on 10,000 Sq.mtrs of area which consists of Overhead Office, Stores and well laid down area for fabrication, machine shop, CNC Operation, Lighting Pole Machinery, Industrial blasting, Power coating plant, Hot-dip galvanization plant and computerized, manual & chemically etched engraving facilities. The workshop is equipped with overhead crane for material handling and other maintenance services.



- 1** 3, 4 & 5 METERS STEPPED POLE
- 2** 6 METERS HINGED POLE
- 3** 4,5 & 6 METERS HIGH CONICAL POLE (S/D ARM BRACKET)
- 4** 8 METERS HIGH CONICAL POLE (S/D ARM BRACKET)
- 5** 10 & 12 METERS HIGH CONICAL POLE (S/D ARM BRACKET)
- 6** 16 METERS HIGH CONICAL POLE (S/D ARM BRACKET)
- 7** 8, 10 & 12 METERS HIGH OCTAGONAL POLE (S/D ARM BRACKET)
- 8** 16 METERS HIGH OCTAGONAL POLE (S/D ARM BRACKET)
- 9** LIGHTING POLE (ARM BRACKETS)
- 10** LIGHTING POLE (ARM BRACKETS)
- 11** 10 & 12 METERS HIGH POLE (MOTOR WAY TYPE)
- 12** ROUND CONICAL POLE WITH LADDER, CAGE AND PLATFORM
- 13** 22 METERS HIGH MAST
- 14** 25 METERS HIGH MAST
- 15** 30 METERS HIGH MAST WITH MOBILE CROWN
- 16** 35 METERS HIGH MAST WITH MOBILE CROWN
- 17** H.T. TRANSMISSION ELECTRICAL POLE-DOUBLE CIRCUIT
- 18** 12 METERS HEAVY DUTY POLE (OCTAGONAL)
- 19** 4 METERS DECORATIVE POLE
- 20** 7.5 METERS DECORATIVE POLE
- 21** TRAFFIC SIGNAL POLE
- 22** CAMERA POLE
- 23** FLAG POLE
- 24** 4, 5 & 6 METERS SOLAR POWERED LIGHT POLE
- 25** STREET LIGHTING CUTOUT
- 26** FEEDER PILLARS
- 27** CONTROL GEAR PANEL
- 28** DETAIL OF CONCRETE FOUNDATION FOR LIGHTING POLE

3, 4 & 5 METERS STEPPED POLE

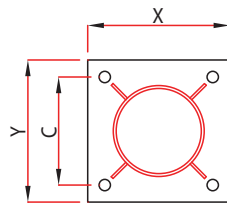
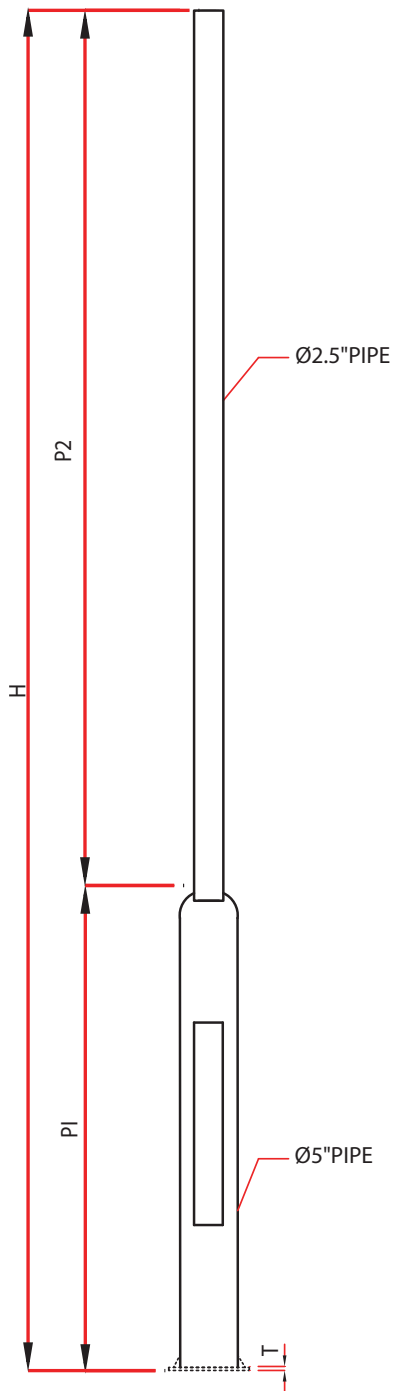

BASE PLATE(10MM T)



H (Mtr)	ØP1 (Mtr)	ØP2 (Mtr)	X x Y x T (mm)	C (mm)	Foundation Bolt Ø x length
3.0	1.2	1.8	300x300x10	230	M20x300
4.0	1.2	2.8	300x300x10	230	M20x400
5.0	1.55	3.45	300x300x10	230	M20x400

6 METERS HINGED POLE

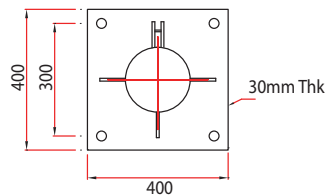
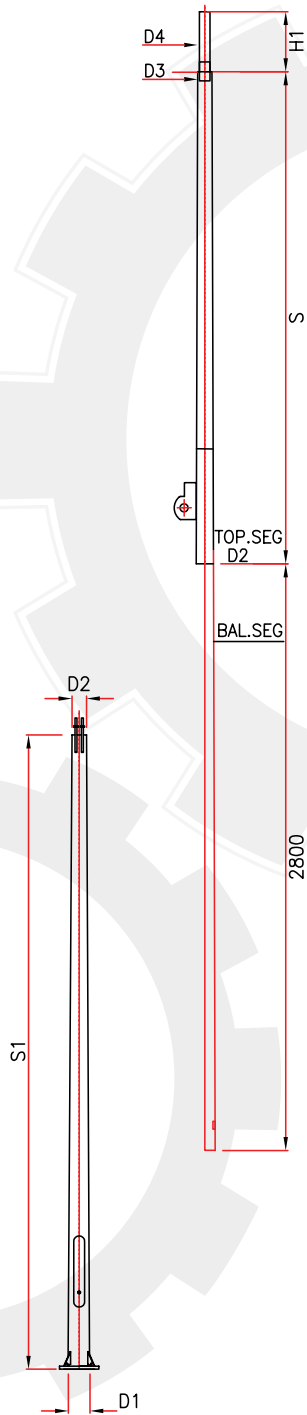

H (Mtr)	S (Mtr)	S1 (Mtr)	H1 (mm)	ØD1 (mm)	ØD2 (mm)	ØD3 (mm)	ØD4 (mm)	X x Y x T (mm)	C (mm)	Foundation Bolt Ø x length
6	2.5	3.2	300	200	140	92	76	400x400x30	300	M30x600

4,5 & 6 METERS HIGH CONICAL POLE (S/D ARM BRACKET)

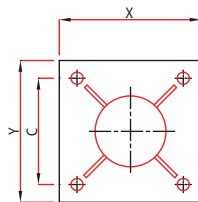
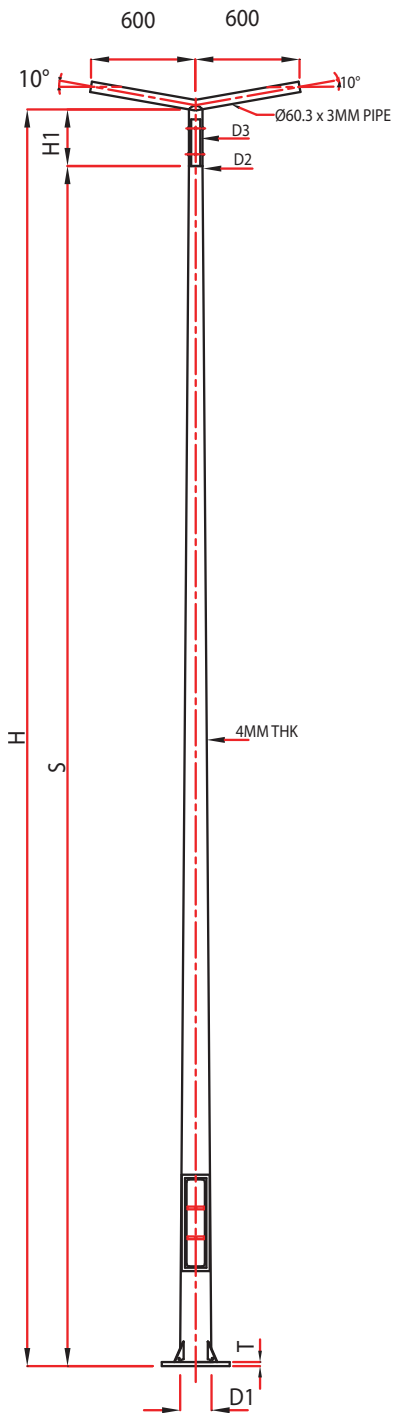

BASE PLATE DETAIL

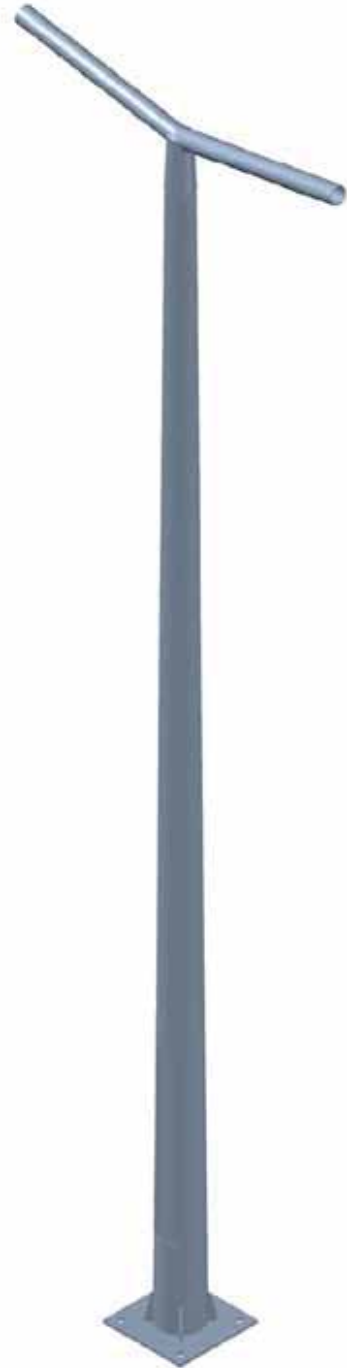

H (Mtr)	S (Mtr)	H1 (mm)	ØD1 (mm)	ØD2 (mm)	ØD3 (mm)	X x Y x T (mm)	C (mm)	Foundation Bolt Ø x length
4.0	3.8	200	150	92	76	300x300x10	230	M20x400
5.0	4.7	300	170	92	76	350x350x20	230	M20x400
6.0	5.7	300	185	92	76	350x350x20	230	M20x400

8 METERS HIGH CONICAL POLE (S/D ARM BRACKET)

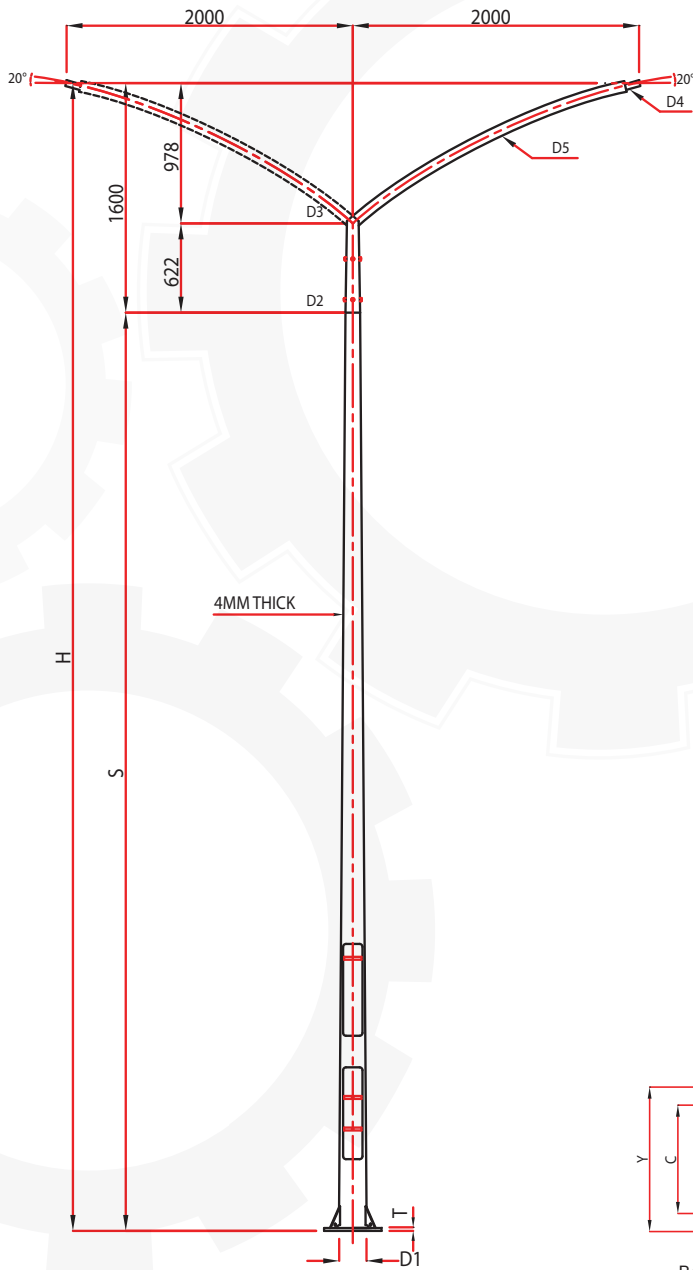

BASE PLATE DETAIL



H (Mtr)	S (Mtr)	ØD1 (mm)	ØD2 (mm)	ØD3 (mm)	ØD4 (mm)	ØD5 (mm)	X x Y x T (mm)	C (mm)	Foundation Bolt Ø x length
8.0	6.4	200	92	76	42	60	400x400x30	300	M30x600

10 & 12 METERS HIGH CONICAL POLE (S/D ARM BRACKET)

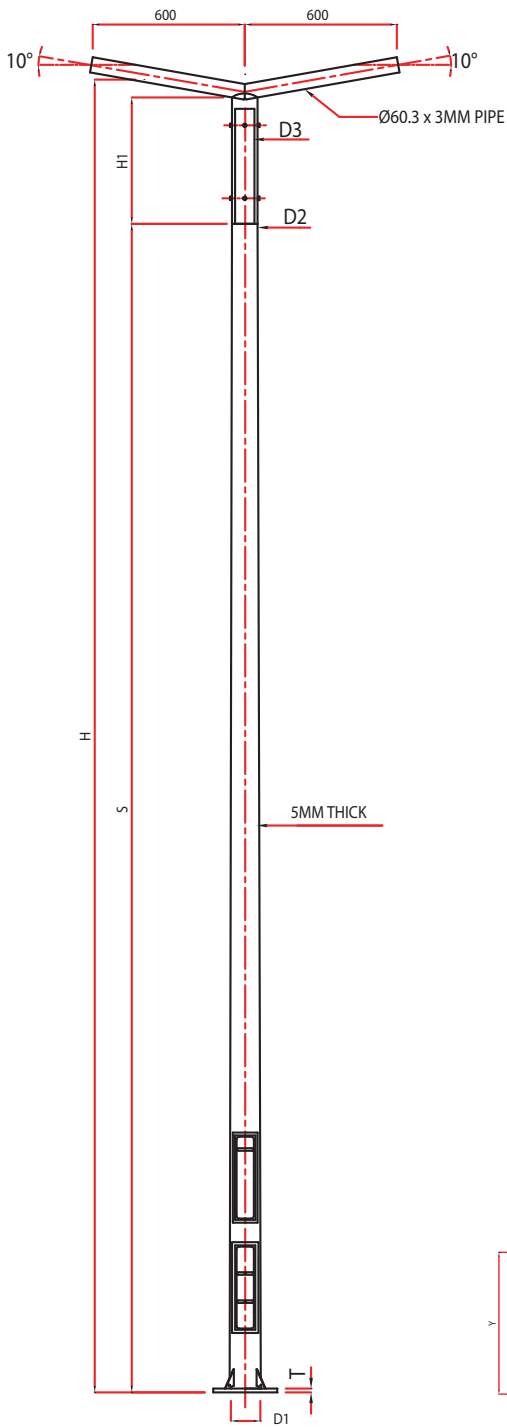

BASE PLATE DETAIL



H (Mtr)	S (Mtr)	H1 (mm)	ØD1 (mm)	ØD2 (mm)	ØD3 (mm)	X x Y x T (mm)	C (mm)	Foundation Bolt Ø x length
10	9.4	600	230	102	89	500x500x30	380	M30x600
12	11.4	600	260	102	89	500x500x30	380	M30x600

16 METERS HIGH CONICAL POLE (S/D ARM BRACKET)

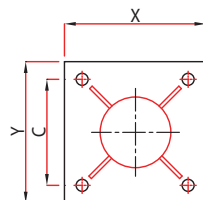
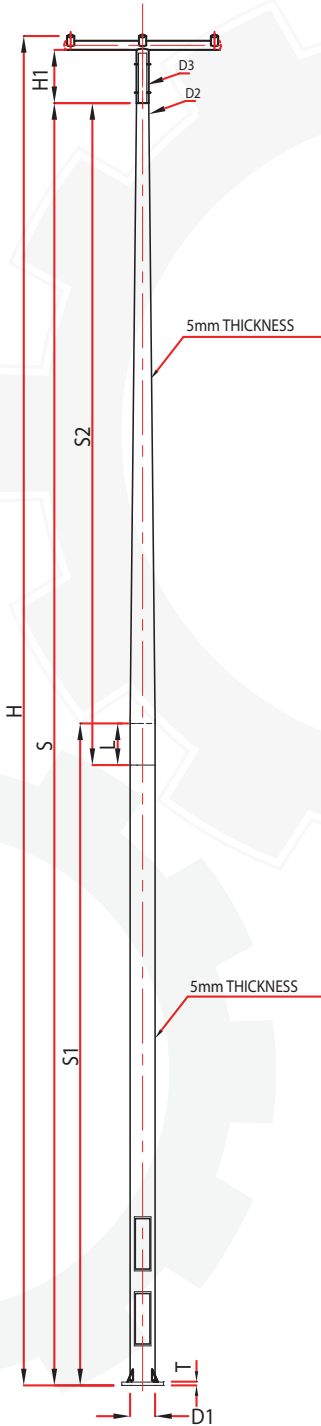

BASE PLATE DETAIL



H (Mtr)	S (Mtr)	S1 (Mtr)	S2 (Mtr)	L (mm)	H1 (mm)	ØD1 (mm)	ØD2 (mm)	ØD3 (mm)	X x Y x T (mm)	C (mm)	Foundation Bolt Ø x length
16	15.4	7.7	8.2	500	600	300	114.5	100	400x400x30	300	M30x600

8, 10 & 12 METERS HIGH OCTAGONAL POLE (S/D ARM BRACKET)

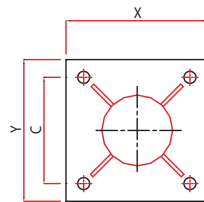
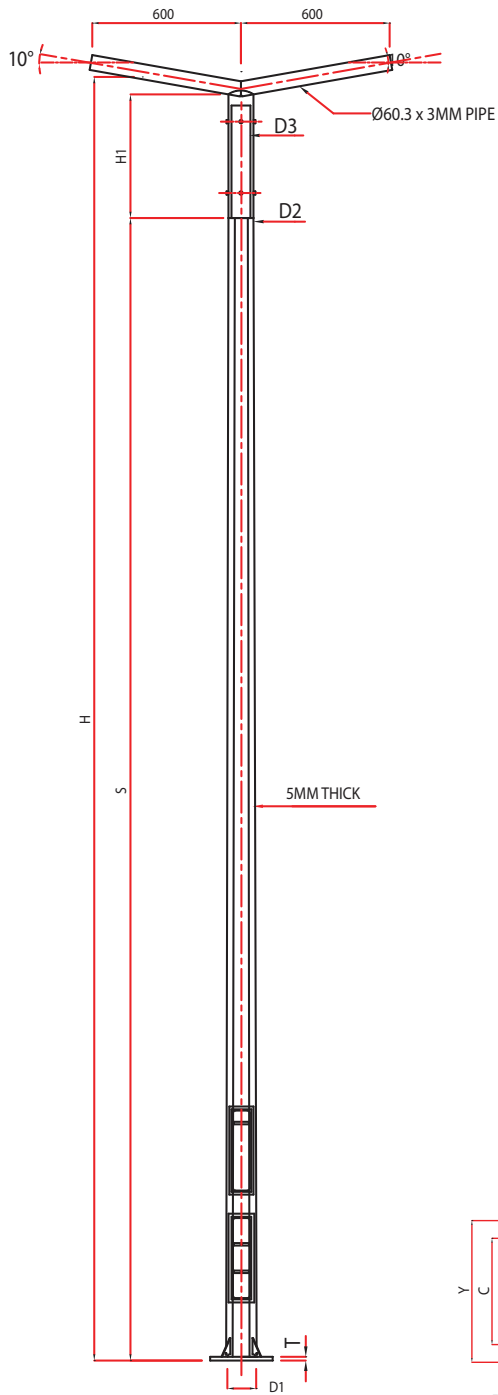

BASE PLATE DETAIL



H (Mtr)	S (Mtr)	H1 (mm)	ØD1 (mm)	ØD2 (mm)	ØD3 (mm)	X x Y x T (mm)	C (mm)	Foundation Bolt Ø x length
8	7.4	600	200	102	89	400x400x30	300	M30x600
10	9.4	600	230	102	89	500x500x30	380	M30x600
12	11.4	600	260	102	89	500x500x30	380	M30x600

16 METERS HIGH OCTAGONAL POLE (S/D ARM BRACKET)

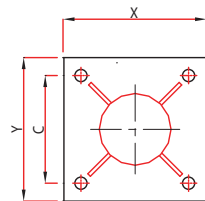
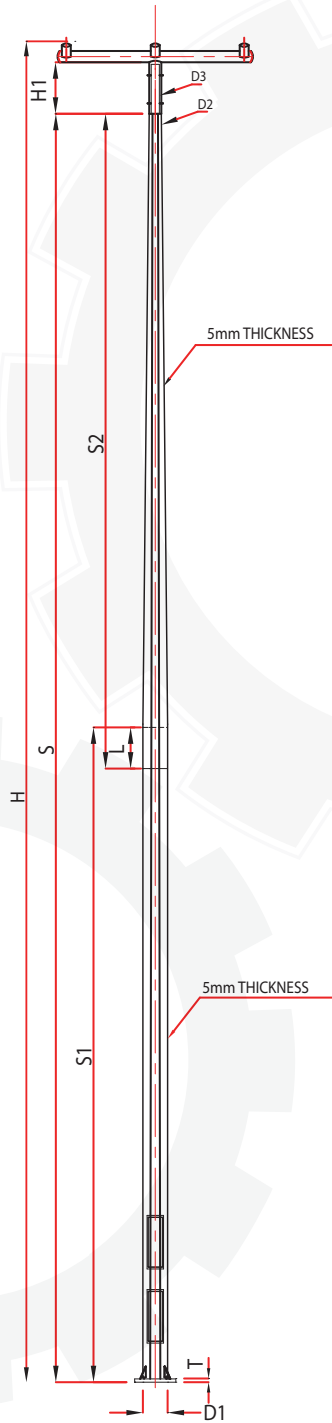

BASE PLATE DETAIL



H (Mtr)	S (Mtr)	S1 (Mtr)	S2 (Mtr)	L (mm)	H1 (mm)	ØD1 (mm)	ØD2 (mm)	ØD3 (mm)	X x Y x T (mm)	C (mm)	Foundation Bolt Ø x length
16	15.4	7.7	8.2	500	600	300	114.5	100	550x550x30	400	M30x900

LIGHTING POLE (ARM BRACKETS)

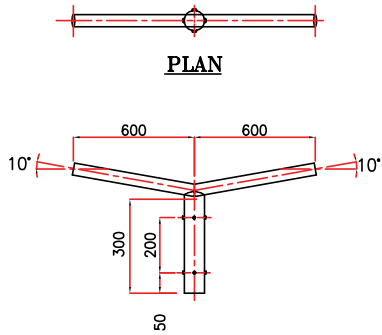

DOUBLE ARM BRACKET DETAIL

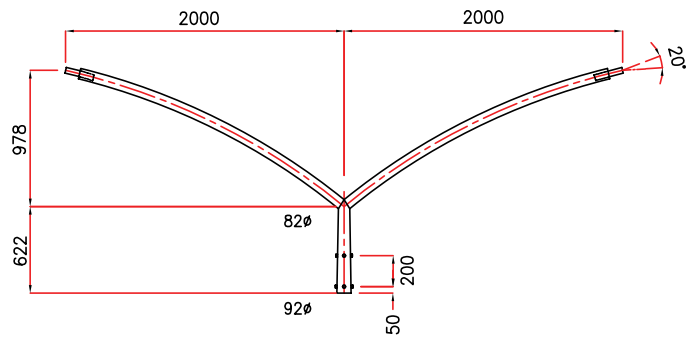

DOUBLE ARM BRACKET DETAIL

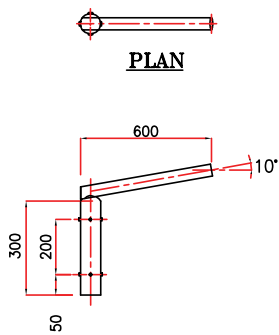

SINGLE ARM BRACKET DETAIL

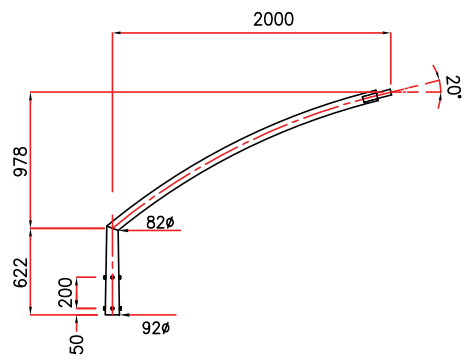

SINGLE ARM BRACKET DETAIL

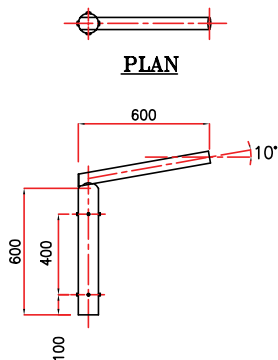

SINGLE ARM BRACKET DETAIL

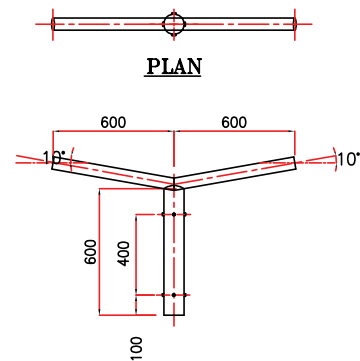

DOUBLE ARM BRACKET DETAIL

LIGHTING POLE (ARM BRACKETS)

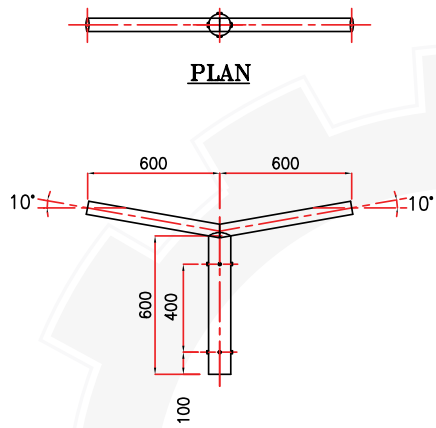

DOUBLE ARM BRACKET DETAIL

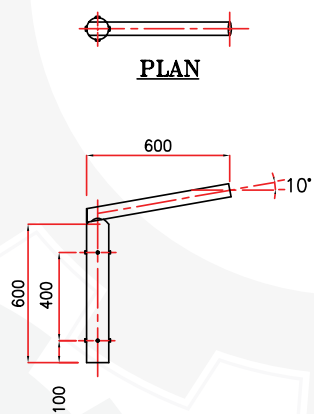

SINGLE ARM BRACKET DETAIL

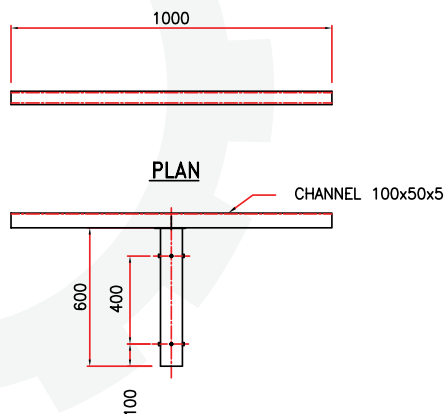

CHANNEL BRACKET

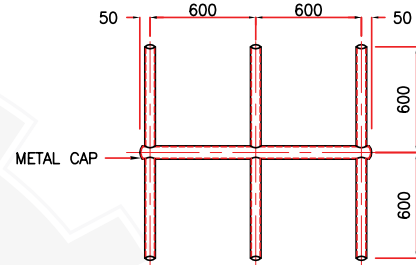

DOUBLE BRACKET DETAIL

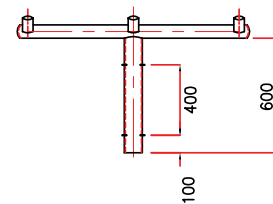

DOUBLE BRACKET DETAIL

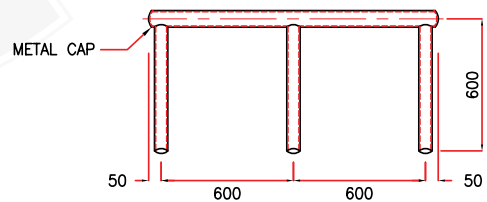

SINGLE BRACKET DETAIL

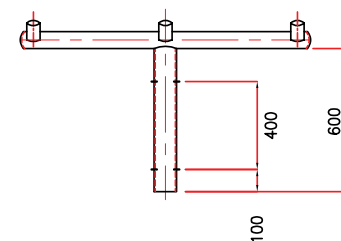

SINGLE BRACKET DETAIL

10 & 12 METERS HIGH POLE (MOTOR WAY TYPE)

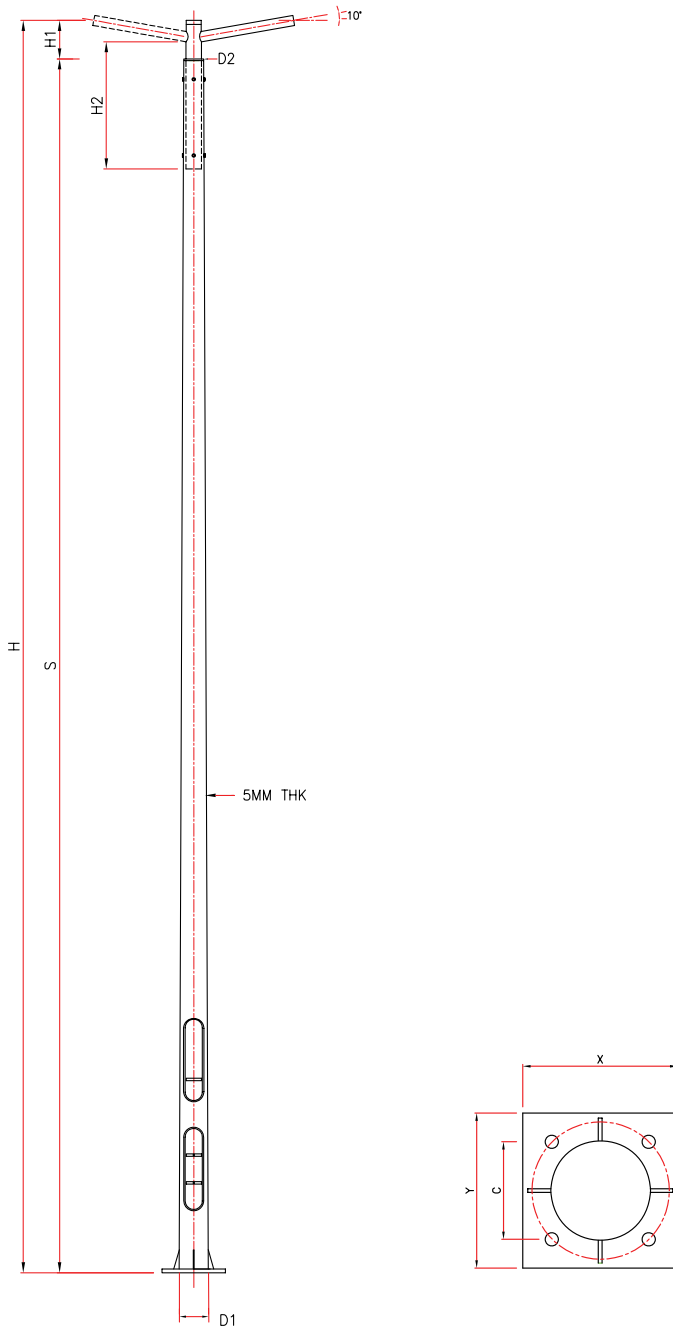

H (Mtr)	S (Mtr)	H1 (mm)	H2 (mm)	ØD1 (mm)	ØD2 (mm)	ØD3 (mm)	X x Y x T (mm)	C (mm)	Foundation Bolt Ø x length
10	9.85	150	600	230	102	76	400x400x30	255	M24x1250
12	11.85	150	600	230	102	76	400x400x30	255	M24x1250

ROUND CONICAL POLE WITH LADDER, CAGE AND PLATFORM

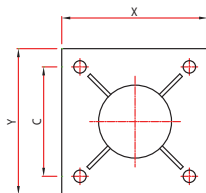
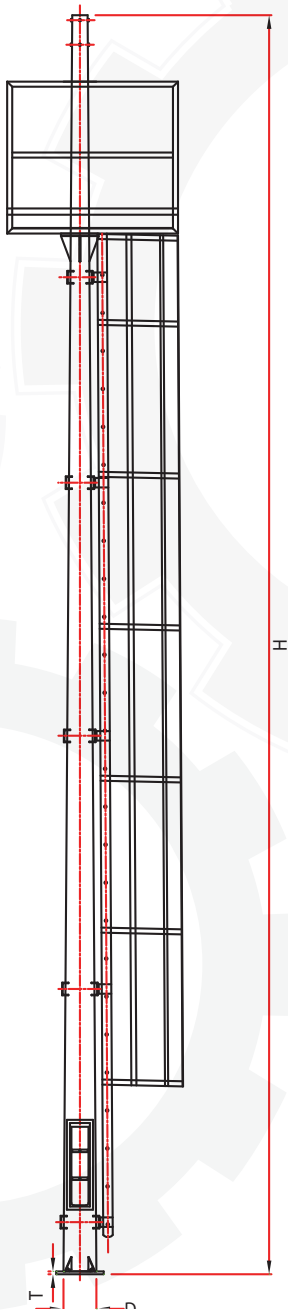

BASE PLATE DETAIL



H (Mtr)	ØD1 (mm)	ØD2 (mm)	X x Y x T (mm)	C (mm)	Foundation Bolt Ø x length
6	200	102	400x400x30	300	M30x600
8	230	120	500x500x30	380	M30x600
10	260	120	500x500x30	380	M30x600
12	260	102	500x500x30	380	M30x600
14	300	132	550x550x30	400	M30x900

22 METERS HIGH MAST

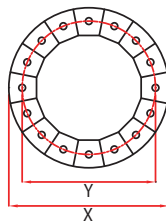
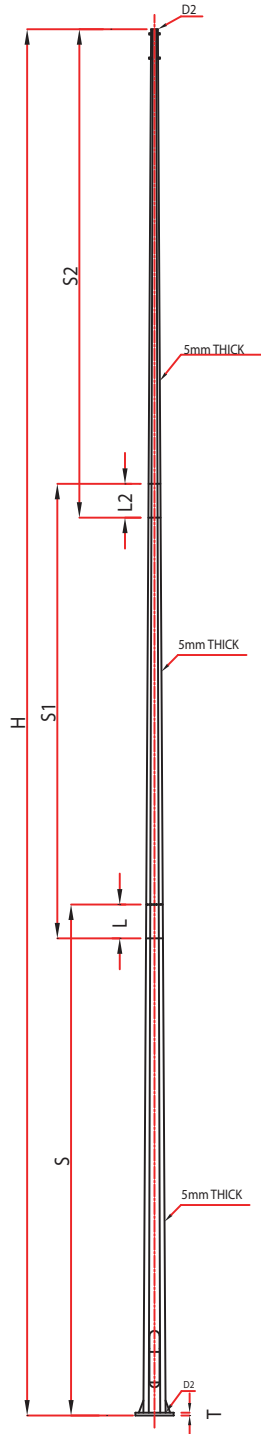

BASE PLATE DETAIL



H (Mtr)	S (Mtr)	S1 (Mtr)	S2 (Mtr)	L (mm)	L1 (mm)	ØD1 (mm)	ØD2 (mm)	X x T (mm)	L (mm)	Foundation Bolt Ø x length
22	9	9	8.5	750	750	480	160	780x40	630	M30x1250

25 METERS HIGH MAST

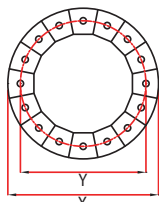
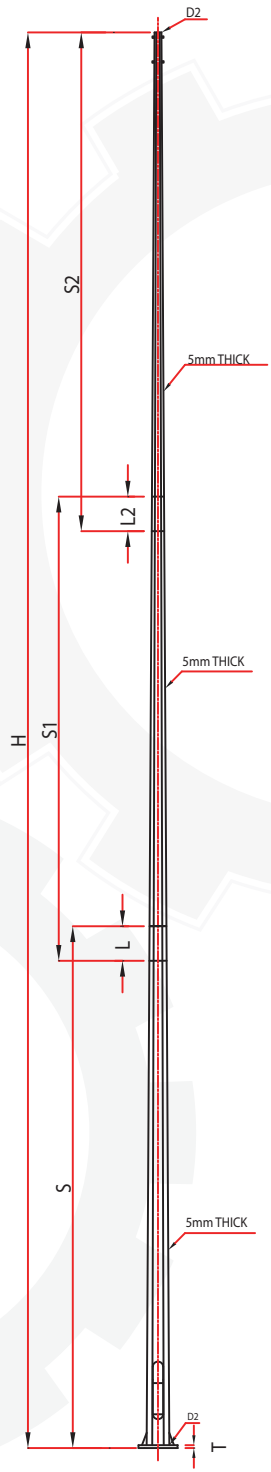

BASE PLATE DETAIL



H (Mtr)	S (Mtr)	S1 (Mtr)	S2 (Mtr)	L (mm)	L1 (mm)	ØD1 (mm)	ØD2 (mm)	X x T (mm)	L (mm)	Foundation Bolt Ø x length
25	9	9	8	750	750	480	160	780x40	630	M30x900

30 METERS HIGH MAST WITH MOBILE CROWN

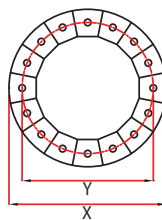
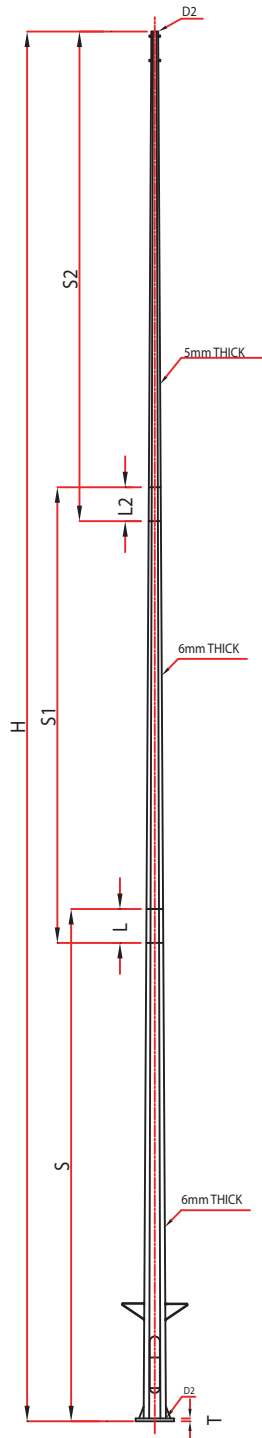

BASE PLATE DETAIL



H (Mtr)	S (Mtr)	S1 (Mtr)	S2 (Mtr)	L (mm)	L1 (mm)	ØD1 (mm)	ØD2 (mm)	X x T (mm)	L (mm)	Foundation Bolt Ø x length
30	11	11	10	750	750	500	180	800x50	650	M30x1200

35 METERS HIGH MAST WITH MOBILE CROWN

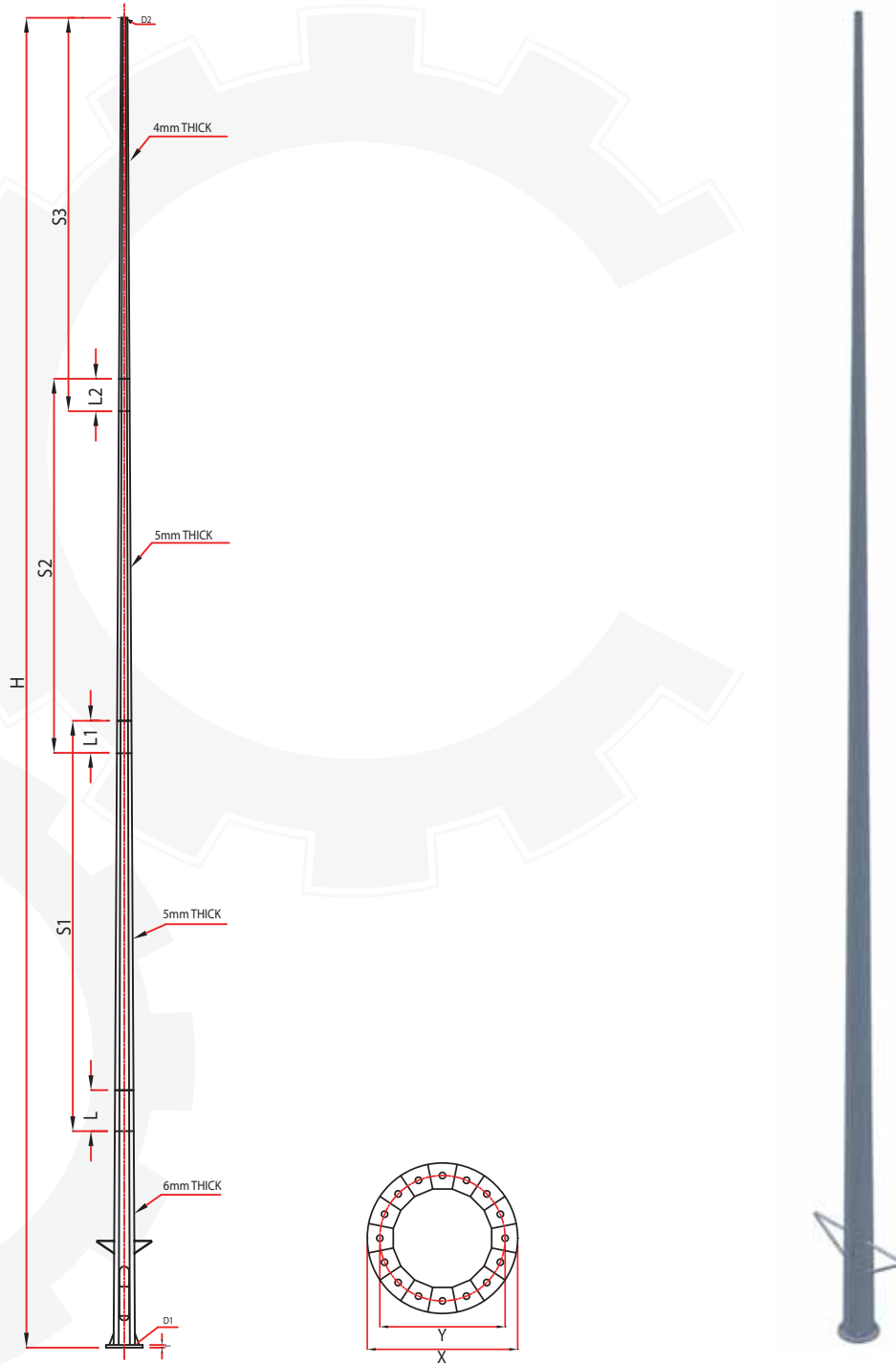

BASE PLATE DETAIL

H (Mtr)	S (Mtr)	S1 (Mtr)	S2 (Mtr)	S3 (Mtr)	L (Mtr)	L1 (mm)	L1 (mm)	ØD1 (mm)	ØD2 (mm)	X x T (mm)	L (mm)	Foundation Bolt Ø x length
35	6.1	10.85	10.65	10	1.1	850	650	680	180	930x50	830	M30x1000

H.T. TRANSMISSION ELECTRICAL POLE-DOUBLE CIRCUIT

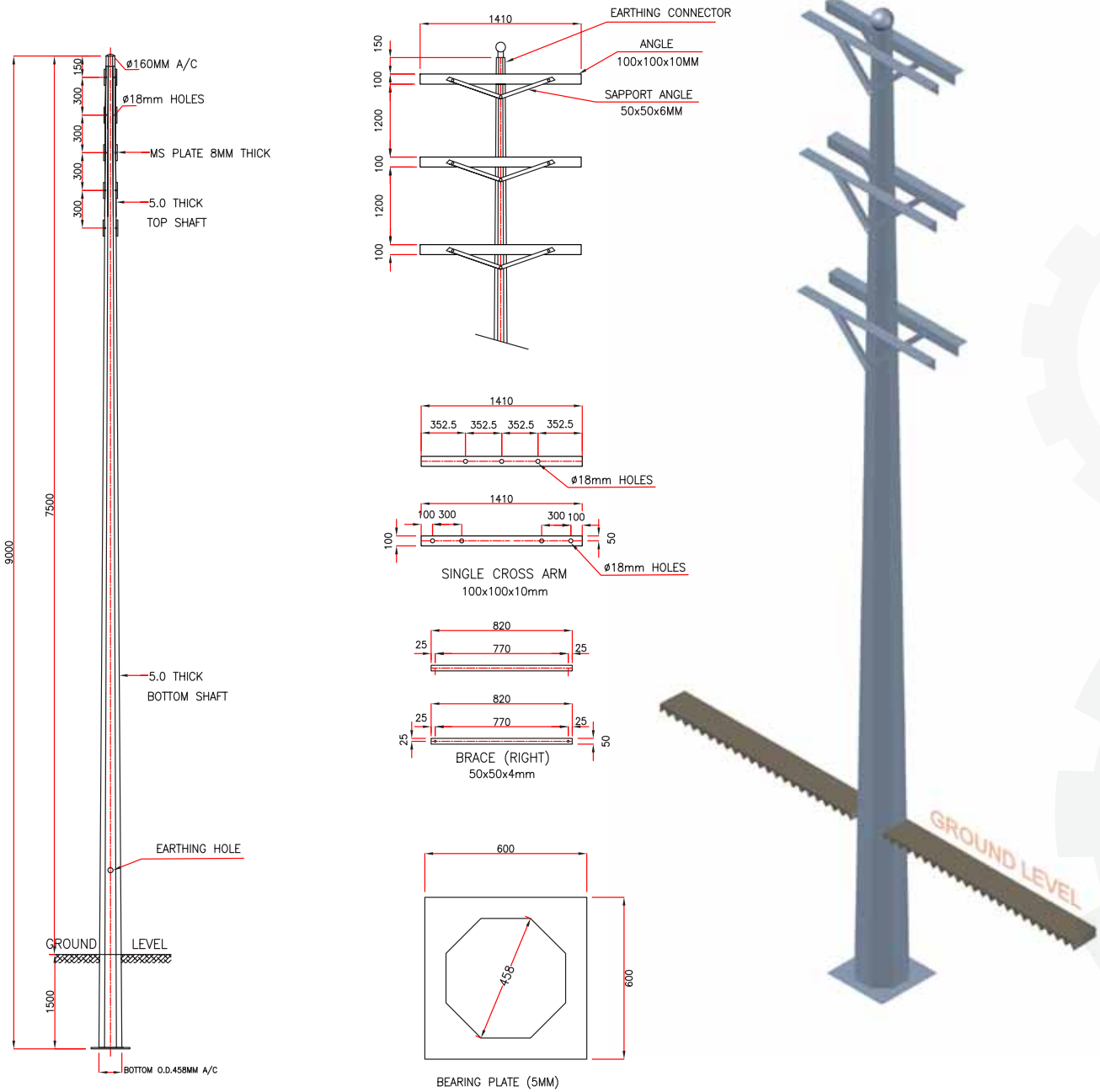

12 METERS HEAVY DUTY POLE (OCTAGONAL)

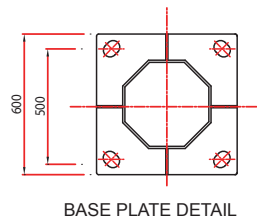
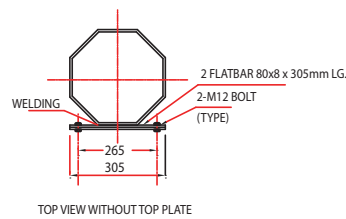
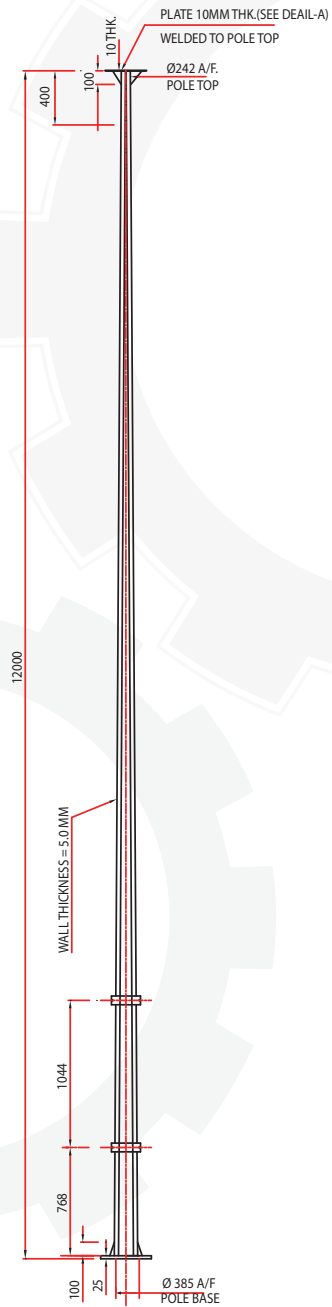

4 METERS DECORATIVE POLE

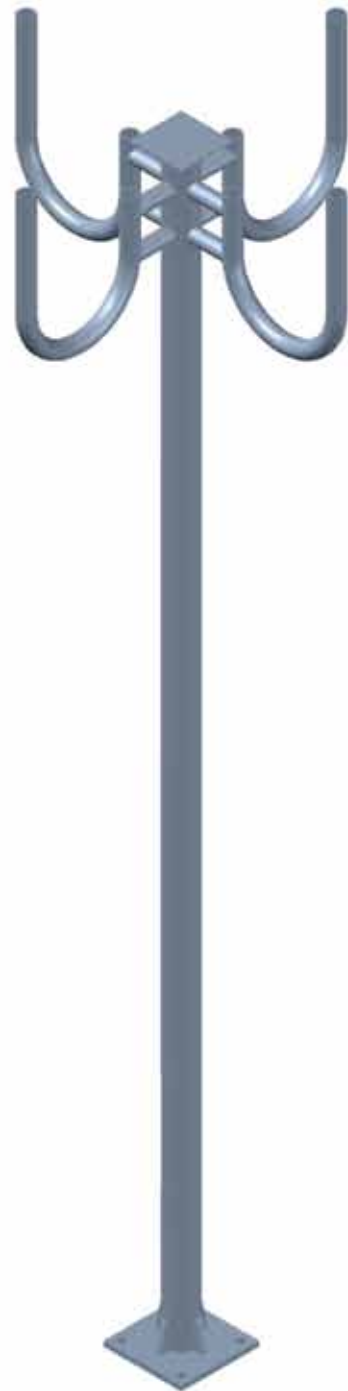
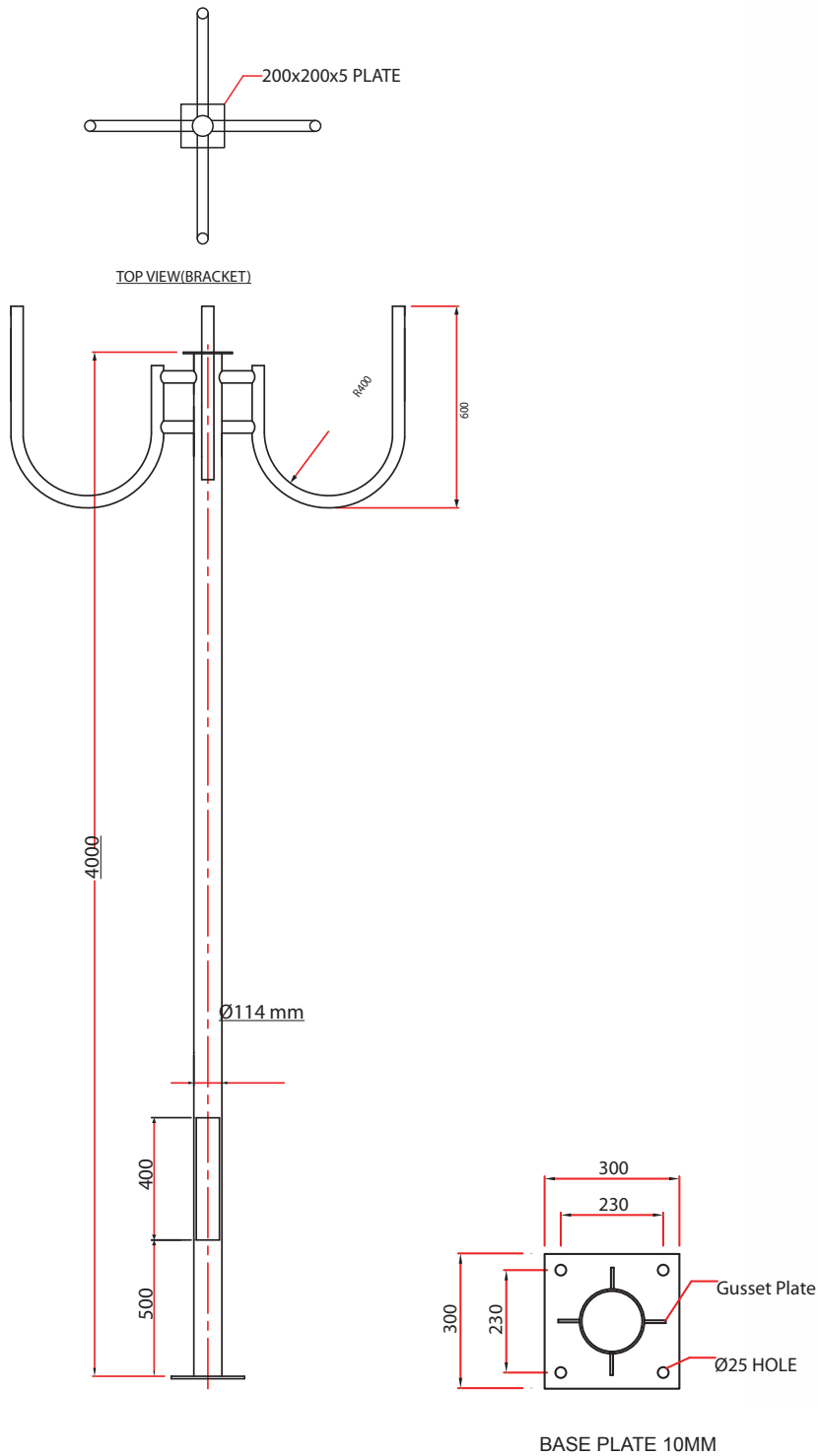

7.5 METERS DECORATIVE POLE

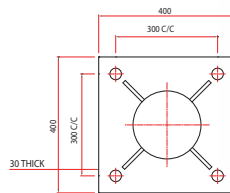
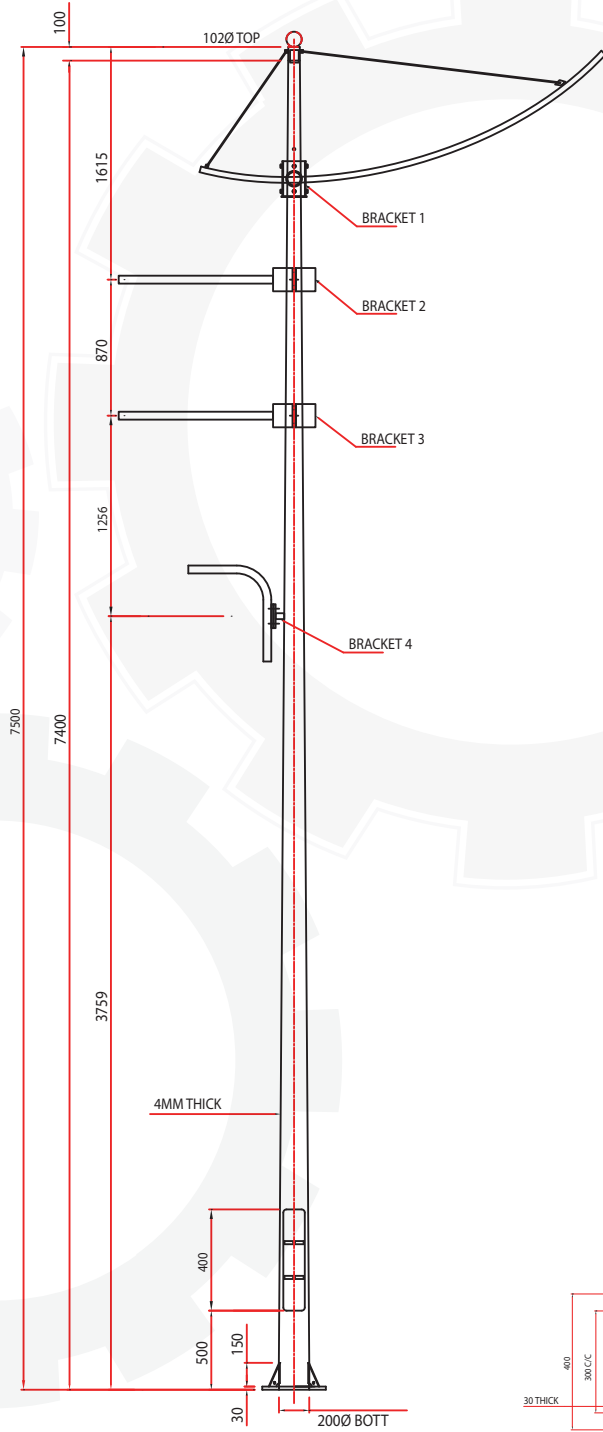

TRAFFIC SIGNAL POLE

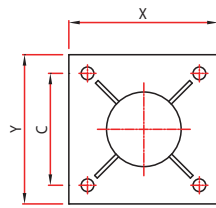
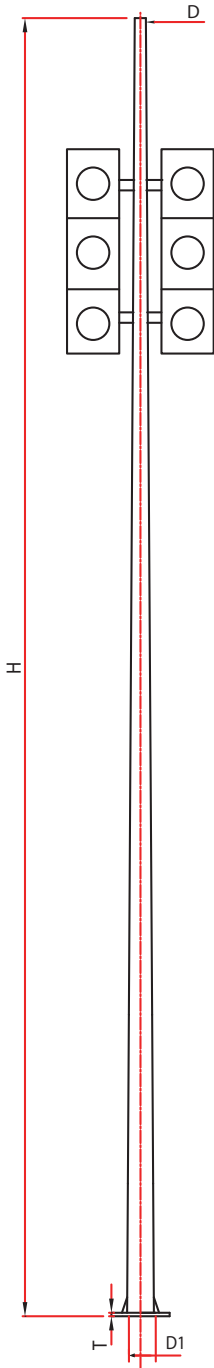

BASE PLATE DETAIL

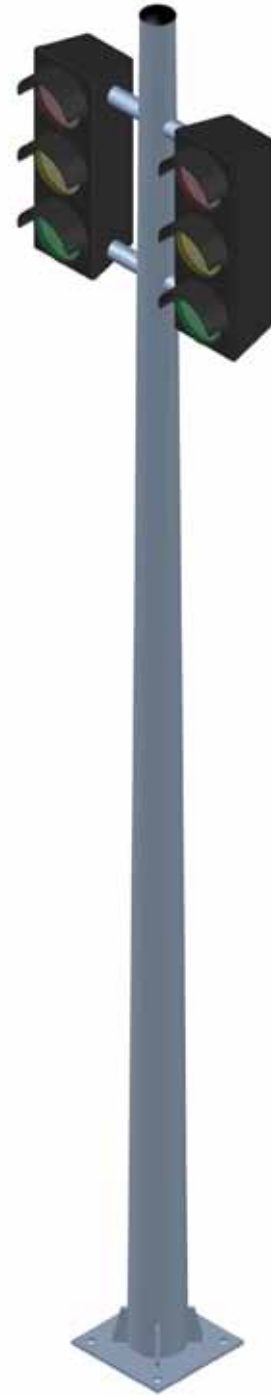

H (mm)	ØD2 (mm)	ØD3 (mm)	XxY x T (mm)	C (mm)	Foundation Bolt Ø x length
4.0	150	92	300x300x10	230	M20x400

CAMERA POLE

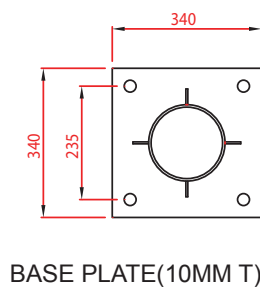
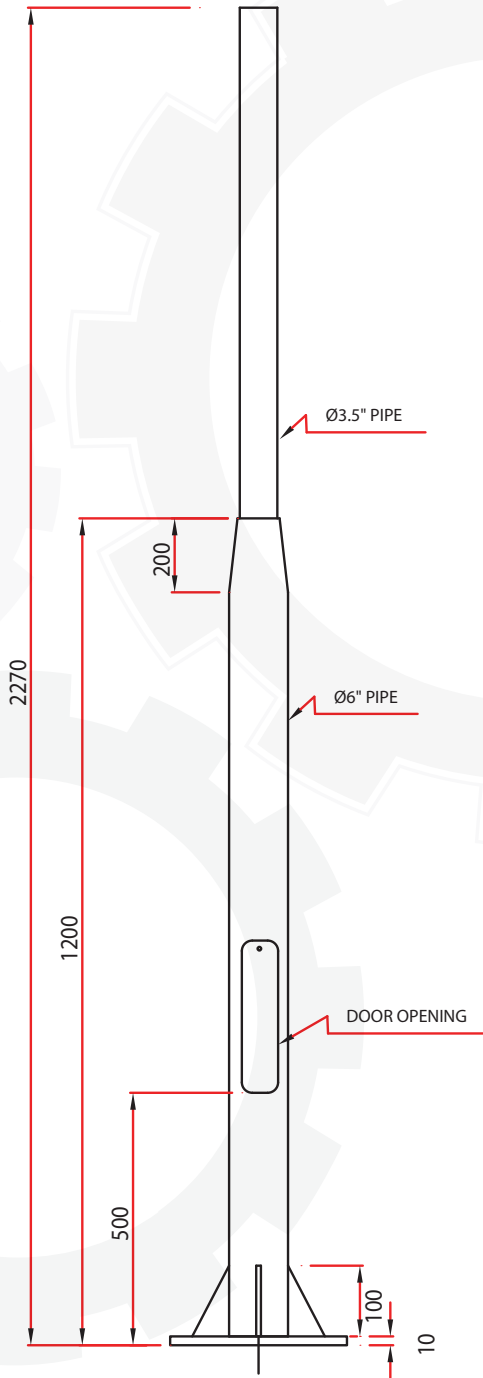

FLAG POLE

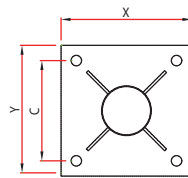
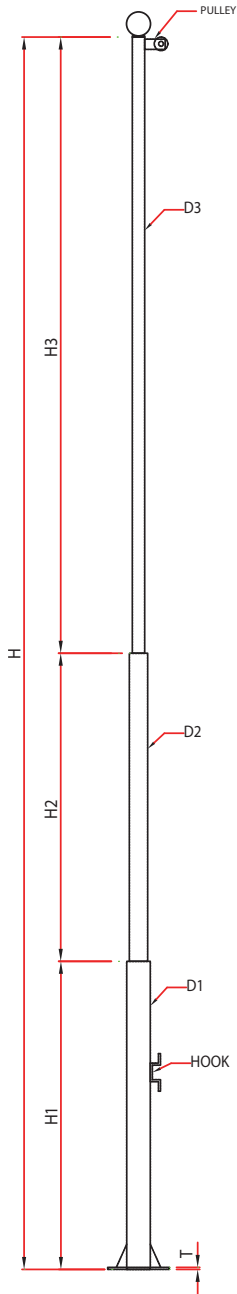

BASE PLATE(10MM T)



H (Mtr)	H1 (Mtr)	H2 (Mtr)	H3 (Mtr)	ØD1 (mm)	ØD2 (mm)	ØD3 (mm)	XxY x T (mm)	C (mm)	Foundation Bolt Ø x length
4	2.5	--	1.5	4"	--	2.5"	300x300x10	230	M20x400
5	3	--	2	4"	--	2.5"	300x300x10	230	M20x400
6	1.5	1.4	3.1	4"	3"	2"	300x300x10	230	M20x400
7	4	--	3	4"	3"	2"	300x300x10	230	M20x400
8	3	3	2	4"	3"	2"	400x400x14	300	M30x600
9	3	3	3	4"	3"	2"	400x400x14	300	M30x600
10	5	3	2	4"	3"	2"	400x400x14	300	M30x600
11	6	3	2	4"	3"	2"	400x400x14	300	M30x600
12	6	4	2	4"	3"	2"	400x400x14	300	M30x600

4, 5 & 6 METERS SOLAR POWERED LIGHT POLE

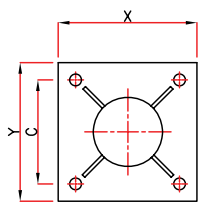
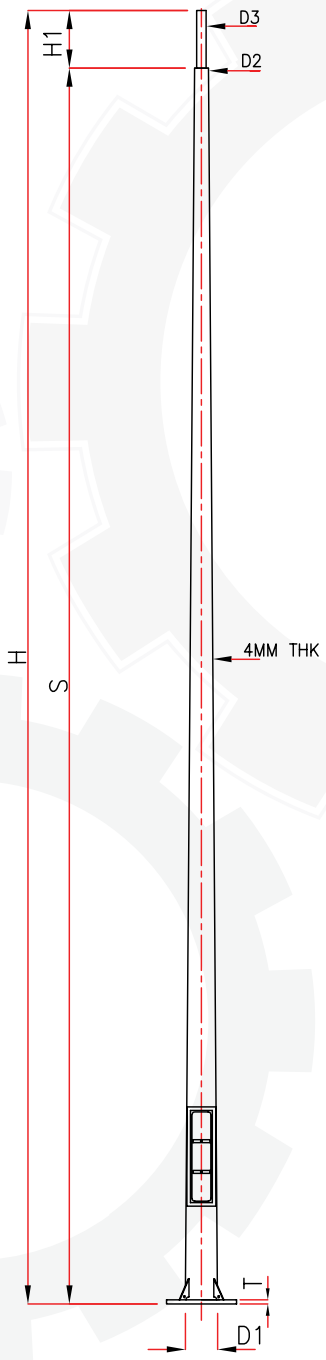

BASE PLATE DETAIL



H (Mtr)	S (Mtr)	H1 (Mtr)	ØD1 (mm)	ØD2 (mm)	ØD3 (mm)	X x Y x T (mm)	C (mm)	Foundation Bolt Ø x length
4.0	3.6	200	150	92	76	300x300x10	230	M20x400
5.0	4.7	300	170	92	76	350x350x20	230	M20x400
6.0	5.7	300	185	92	76	350x350x20	230	M20x400

STREET LIGHTING CUTOUT

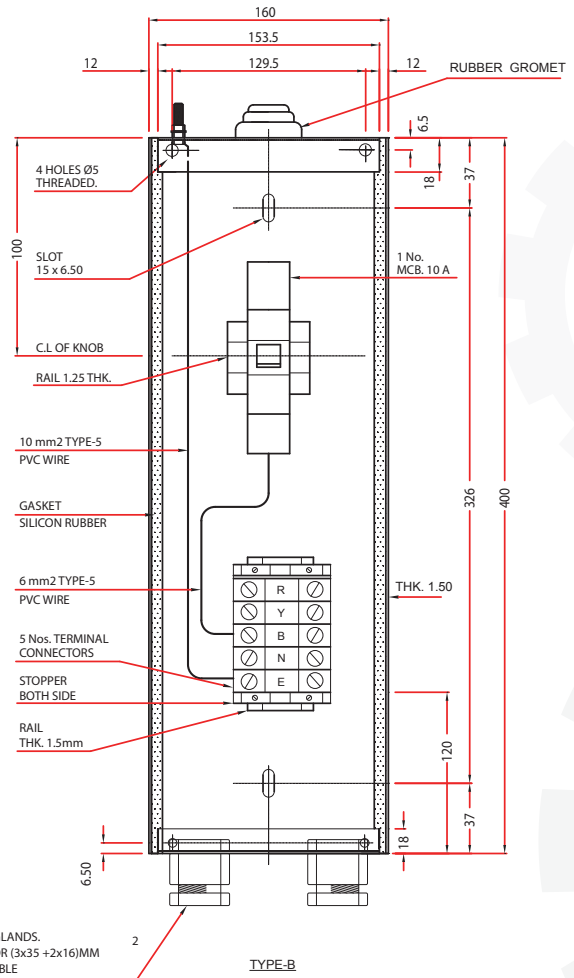
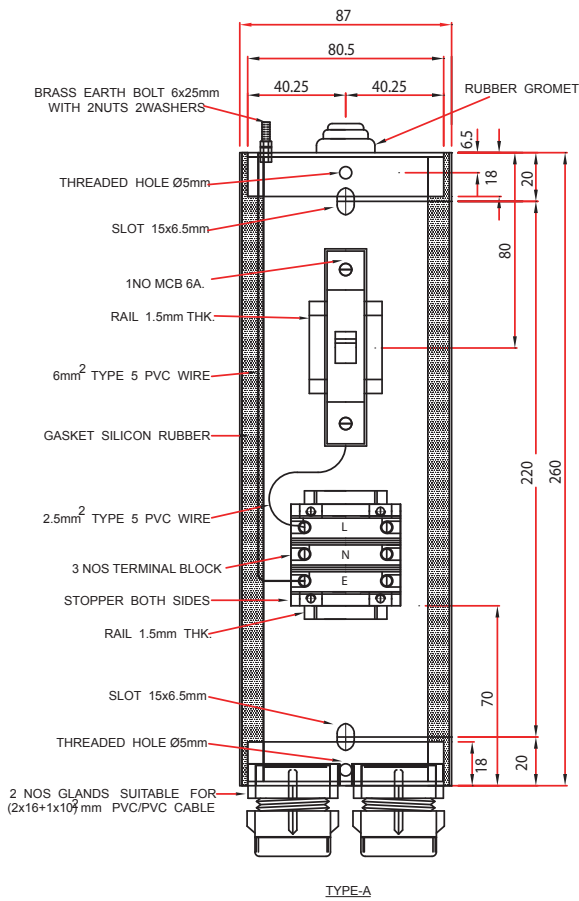
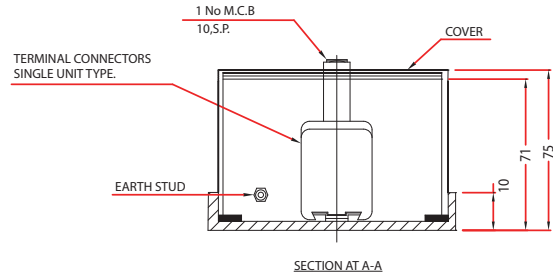
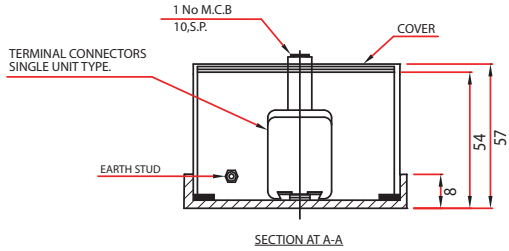

DECRPTION	APLICATION	TYPE
1x6 A	4 METER & 8MTR S/A & D/A	TYPE-A
1x10 A	10 METER S/A & D/A	TYPE-A
1x20 A	12 METER S/A	TYPE-B
2x20 A	12 METER D/A	TYPE-B
3x20 A	16 METER S/A & D/A	TYPE-B

FEEDER PILLARS

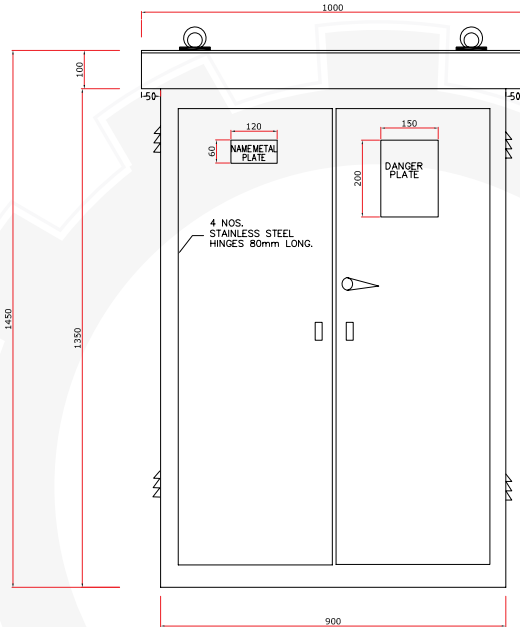

FRONT VIEW

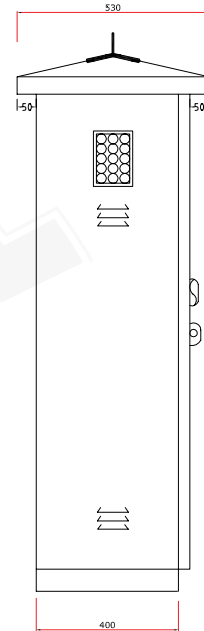

SIDE VIEW

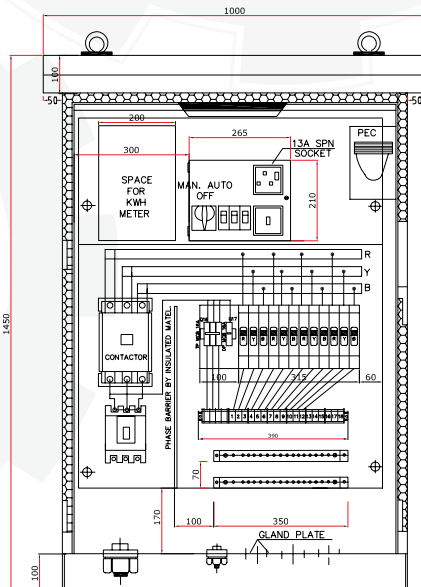

ELEVATION
DOOR REMOVED

DESCRIPTION

TYPE-A, TYPE-C, TYPE-D OR ANY OTHER MODEL SPECIFIC ARE AVAILABLE

CONTROL GEAR PANEL

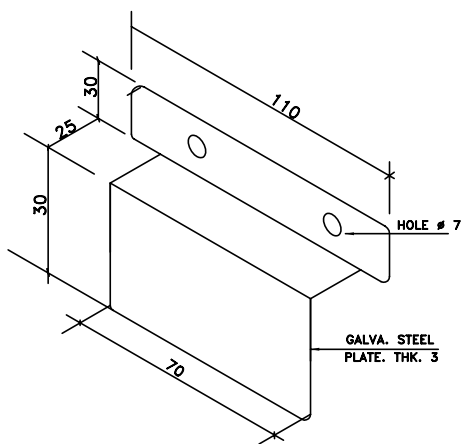
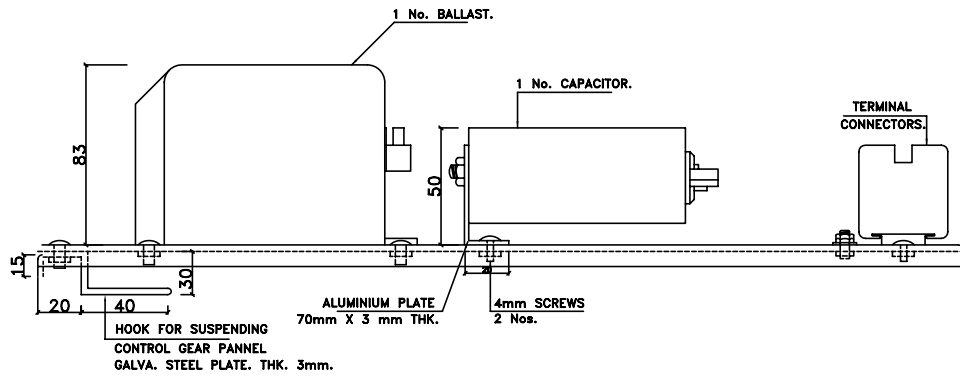
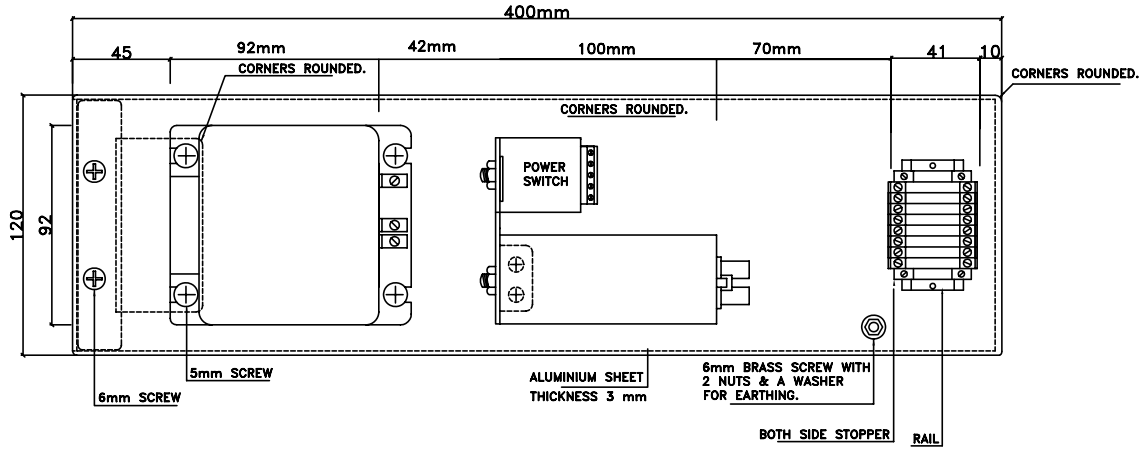

HANGING HOOK.

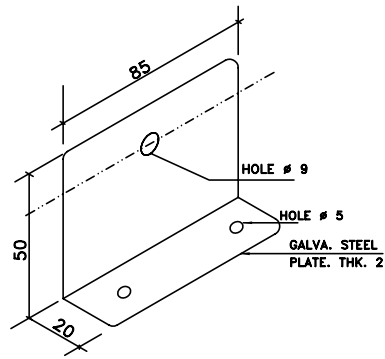

CAPACITORS MOUNTING PLATE.

DESCRIPTION

1x150,2x150-1x250,2x250

1x400,2x400,3x400-2x600

DETAIL OF CONCRETE FOUNDATION FOR LIGHTING POLE

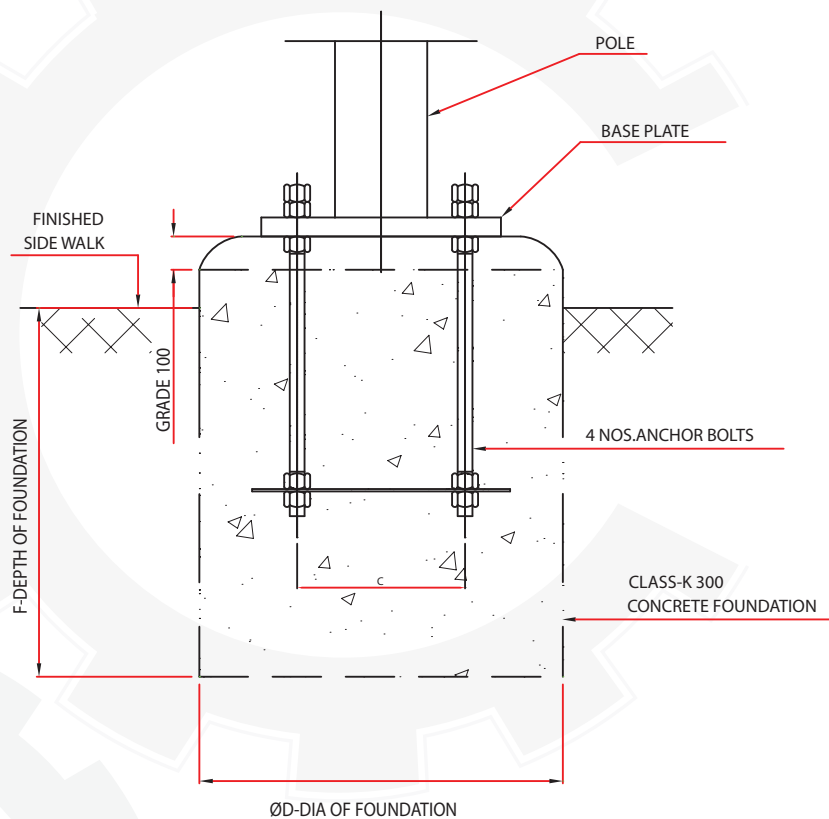

HEIGHT OF POLE	DIAMETER "D"	DEPTH "F"	GROUT "G"	NO. OF D-16 BARS	CENTRE- "C"	Foundation Bolt Ø x Length
16 Mtr.	900 mm	2.5 M	80	12	400	M30 x 900
12 Mtr.	900 mm	2.3 M	60	12	380	M30 x 600
10 Mtr.	900 mm	1.5 M	60	12	380	M30 x 600
8 Mtr.	900 mm	1.5 M	50	12	300	M30 x 600
4 Mtr.	650 mm	1.0 M	40	4	230	M20 x 400

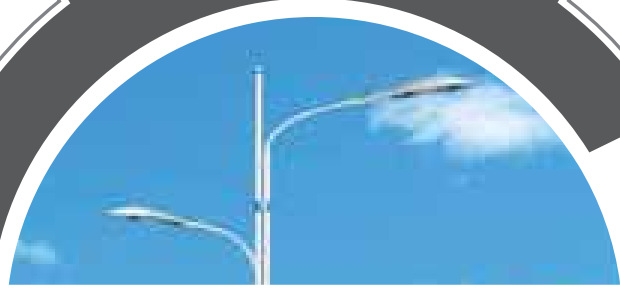

المير للصناعات ALMEER INDUSTRIES

HEAD OFFICE: P.O. Box 9240 Ahmadi, 61003 Kuwait

Tel. : +965 2398 6594 (10 Lines)

Hotline: 18 40 800

Fax : +965 2398 0682 / 6574

E-mail : atsco@almeer.com.kw



www.almeer.com.kw

FACTORY: AMGHARA INDUSTRIAL AREA

Tel. : +965 2457 1395 / 4391

Fax : +965 2457 1396

E-mail : factory@almeer.com.kw